

Engine Stand Assembly



Non Printed Parts

Part Description	Quantity
3/4" x 1/16" Aluminum Square Tube - 9.625" long	2
3/4" x 1/16" Aluminum Square Tube -7.5" long	1
9mm Aluminum Rod - 3.325" long (Mount Spindle)	1
5mm Aluminum Rod - 5" long (Handle)	1
5mm Aluminum Rod - .75" long (Handle 2)	1
1/8" x 1/2" Aluminum Flat Bar - 2" long (Engine mount fingers)	4
1/8" x 2" Aluminum Flat Bar - 3.5" long (Engine Mount Flange)	1
608zz Bearing	2
#8 Stainless Hex Sheet Metal Screw	18
#8 Stainless Flat Washer	18
M3 Flat Washer	26
M3 Fender Washer	4
M3 Hex Nut	11
M3 Lock Nut	9
M3 x 8mm Set Screw	2
M3 x 12mm SHCS	4
M3 x 16mm SHCS	4
M3 x 18mm SHCS	4
M3 x 25mm SHCS	1
M3 x 30mm SHCS	4
M3 x 35mm SHCS	2
M3 x 45mm SHCS	3

Printed Parts List

Part Description	Quantity	Printing notes
Spindle flange mount spacer	1	Minimum 80% infill, 95% ideal
Spindle spacer handle mount - No Glue	1	Minimum 80% infill, 95% ideal
Tube end cap	2	
Wheel end mount - Left	1	Minimum 80% infill, 95% ideal
Wheel end mount - Right	1	Minimum 80% infill, 95% ideal
Wheel Spacer 2	2	
Wheel spacer	4	
Caster Wheel Bracket	2	Minimum 80% infill, 95% ideal
Caster wheel flange	2	Minimum 80% infill, 95% ideal
Engine Mount Spacer	4	
Fixed Wheel	2	Minimum 80% infill, 95% ideal
Printed bracket 1 - mirror	1	Minimum 80% infill, 95% ideal
Printed bracket 1	1	Minimum 80% infill, 95% ideal
Printed bracket 2	1	Minimum 80% infill, 95% ideal
Printed bracket 4	1	Minimum 80% infill, 95% ideal
Printed bracket 5	1	Minimum 80% infill, 95% ideal
Printed bracket 6	1	Minimum 80% infill, 95% ideal
Printed bracket 7	1	Minimum 80% infill, 95% ideal

Tools and materials needed

Drill press or hand drill

Assortment of drill bits

Superglue

Metric allen wrenches

Spray paint if desired

Center Horizontal 3/4" x 1/16" Aluminum Square Tube

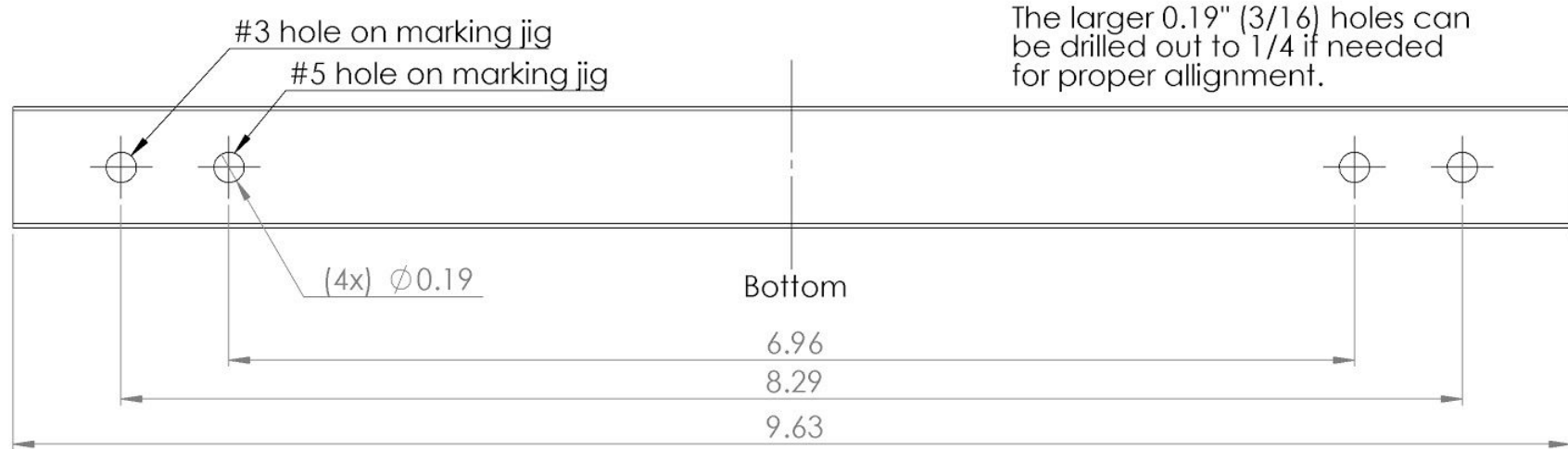

Center Vertical 3/4" x 1/16" Aluminum Square Tube

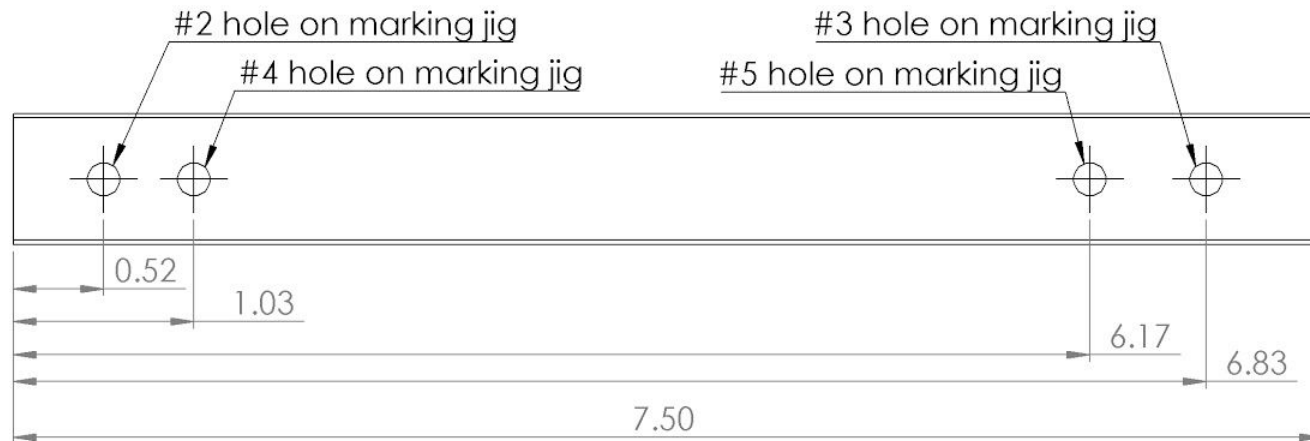

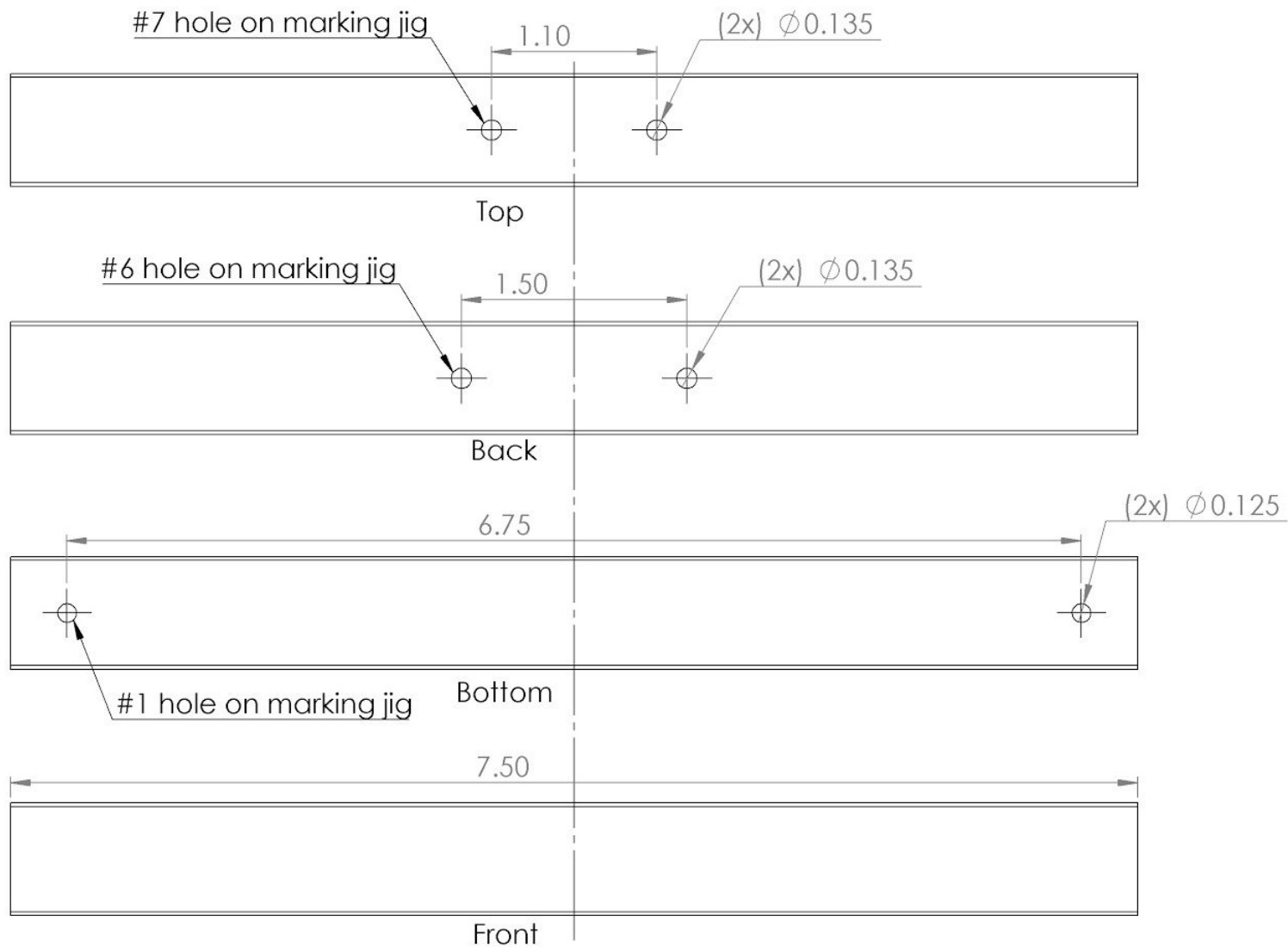

Front 3/4" x 1/16" Aluminum Square Tube

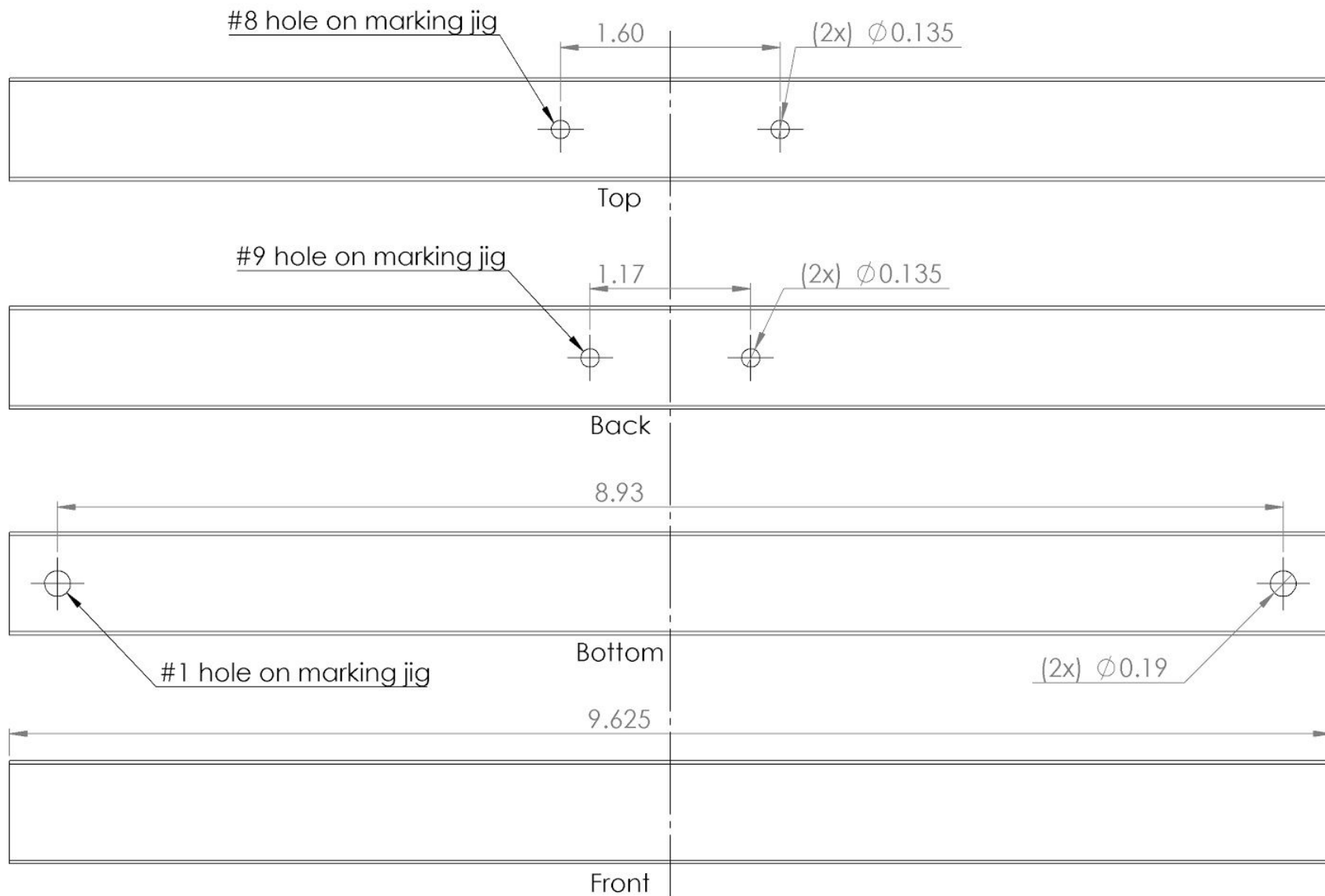

Rear 3/4" x 1/16" Aluminum Square Tube

Engine Stand Flange Dimensions

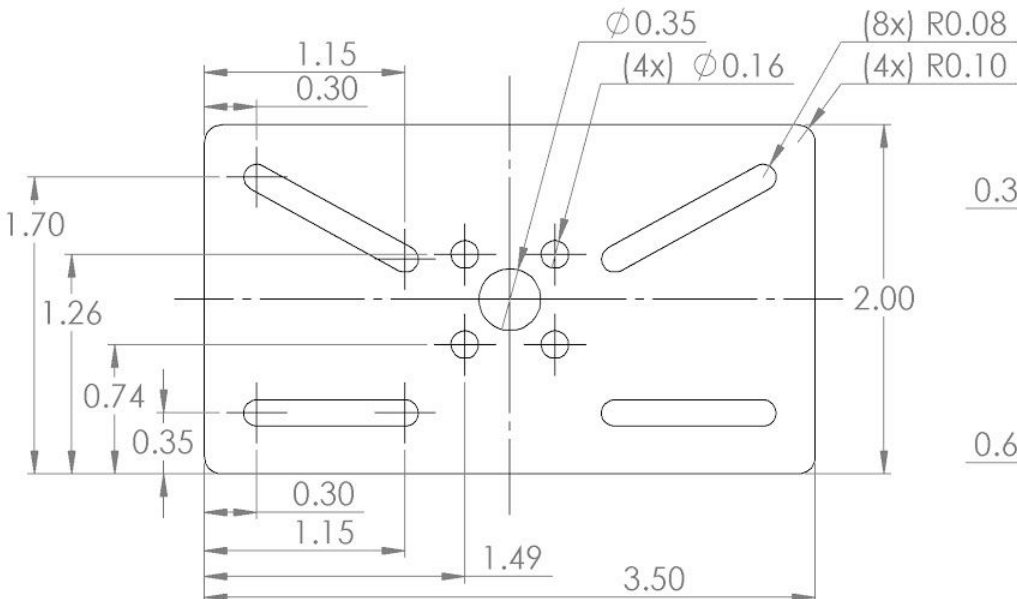

Universal Flange

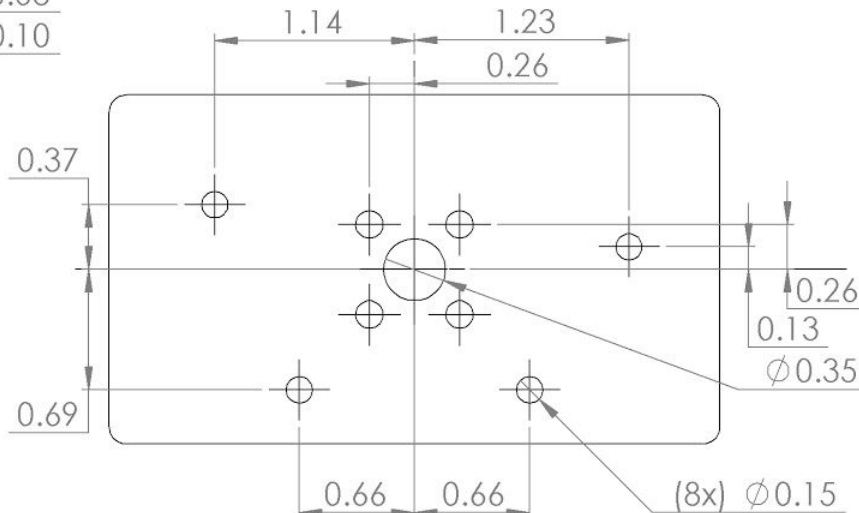

Subaru EJ20 Back Side

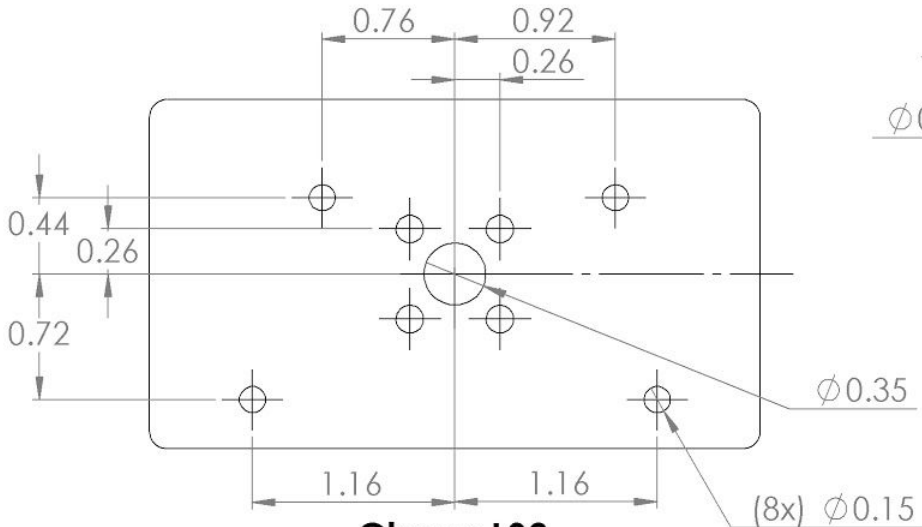

Chevy LS3 Back Side

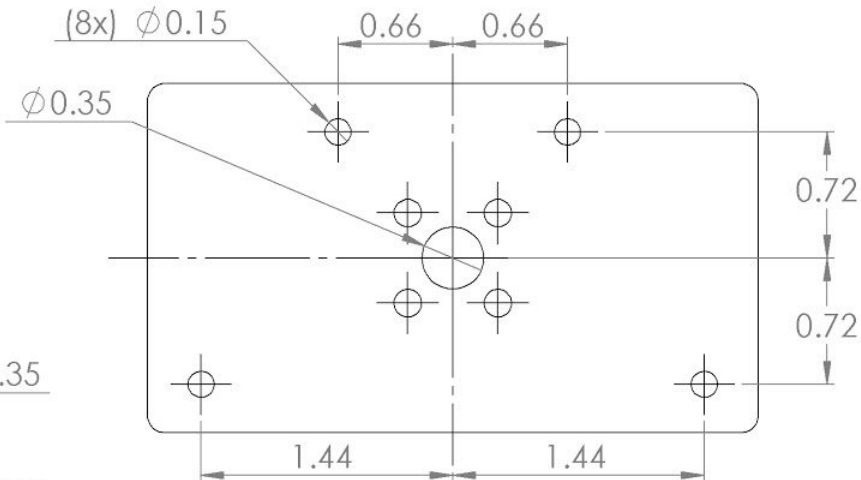

Toyota 22R Back Side

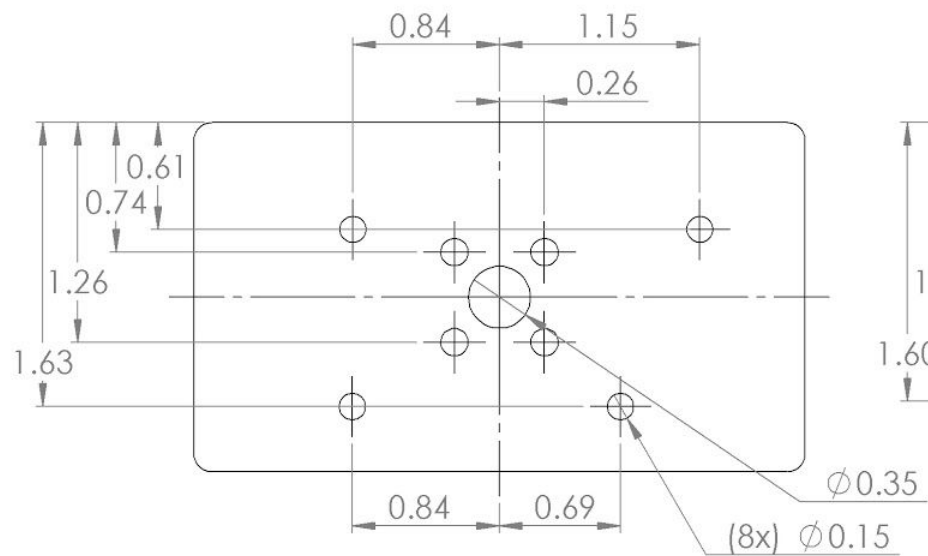

**Mazda 13B-REW
Back Side**

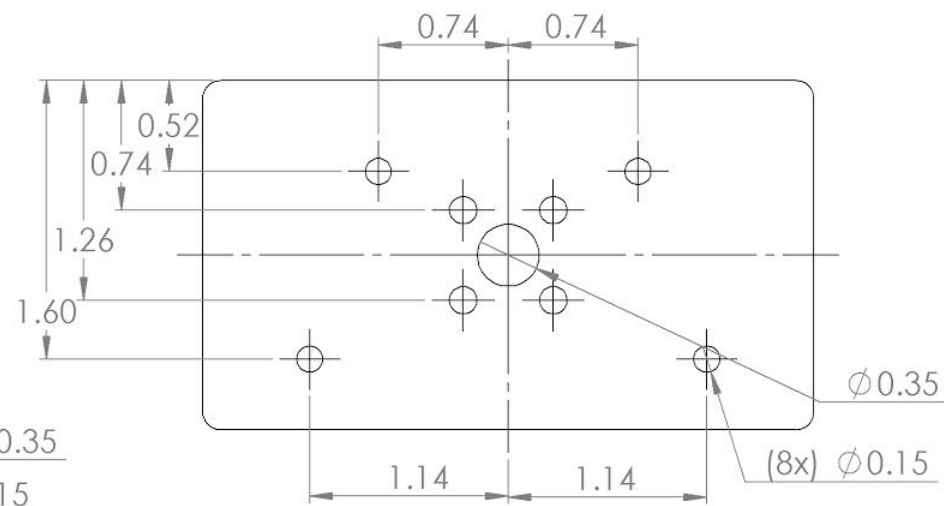

**Ford Flathead V8
Back Side**

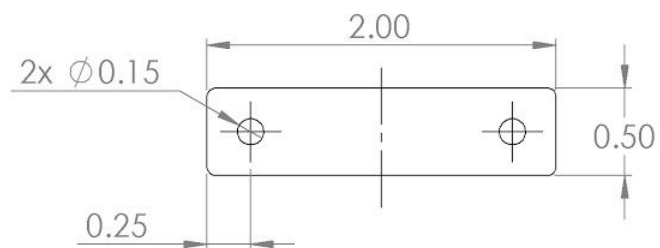

Engine Mount Finger

Engine Stand Base Assembly

ITEM NO.	PART NUMBER	QTY.
1	Center Horizontal Square Tube - 9.625"	1
2	Rear Square Tube - 9.625"	1
3	Front Square Tube - 7.5"	1
4	Center Vertical Square Tube - 7.5"	1
5	Printed bracket 1 - mirror	1
6	Printed bracket 1	1
7	Printed bracket 2	1
8	Printed bracket 4	1
9	Printed bracket 5	1
10	#8 Flat Washer	14
11	#8 x 3/4" Hex Head Screw	14

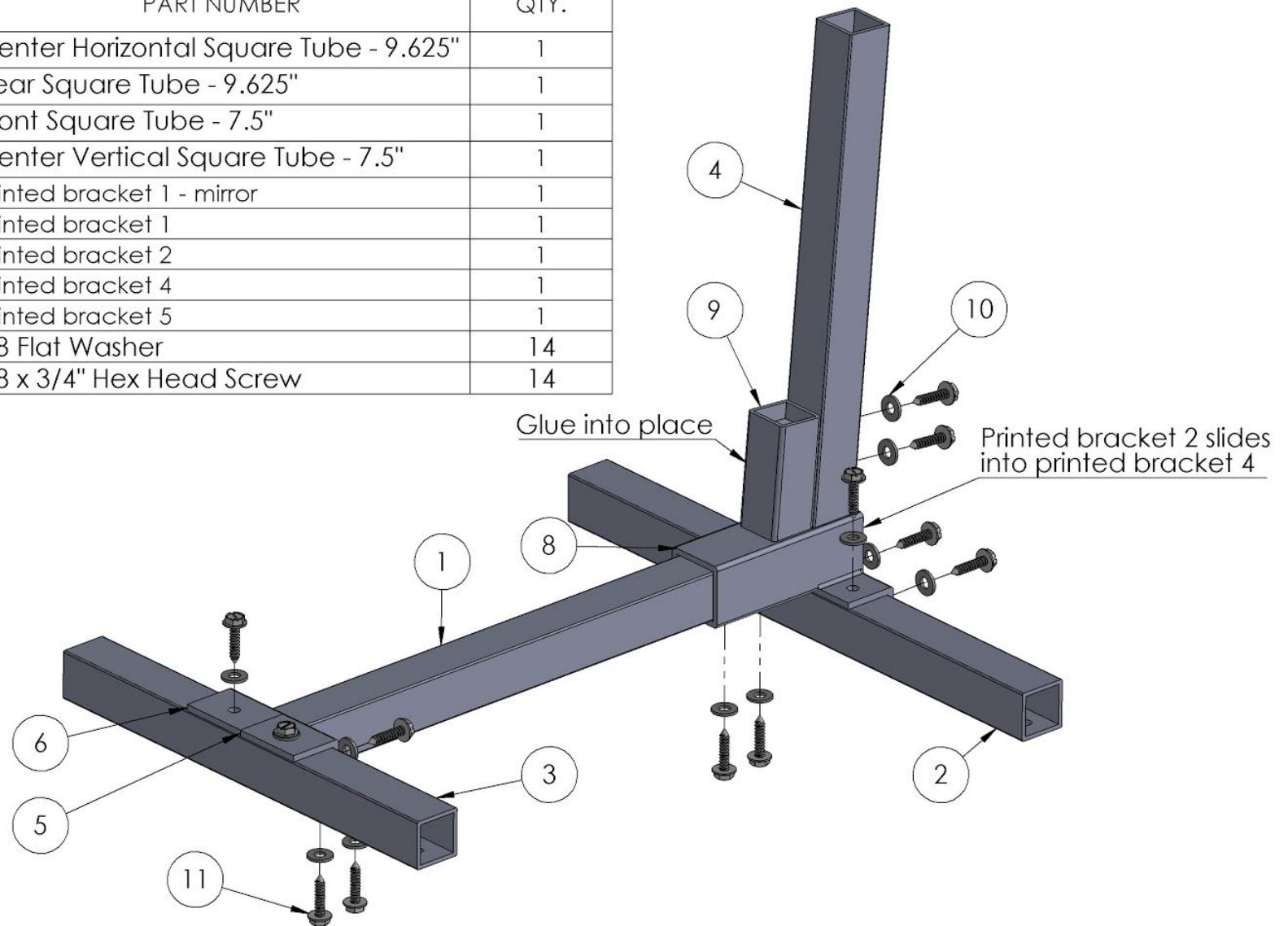

Spindle Head Assembly

ITEM NO.	PART NUMBER	QTY.
1	Printed bracket 6	1
2	M3 Hex Nut	3
3	M3 x 45mm SHCS	3
4	M3 Nylon Lock Nut	1

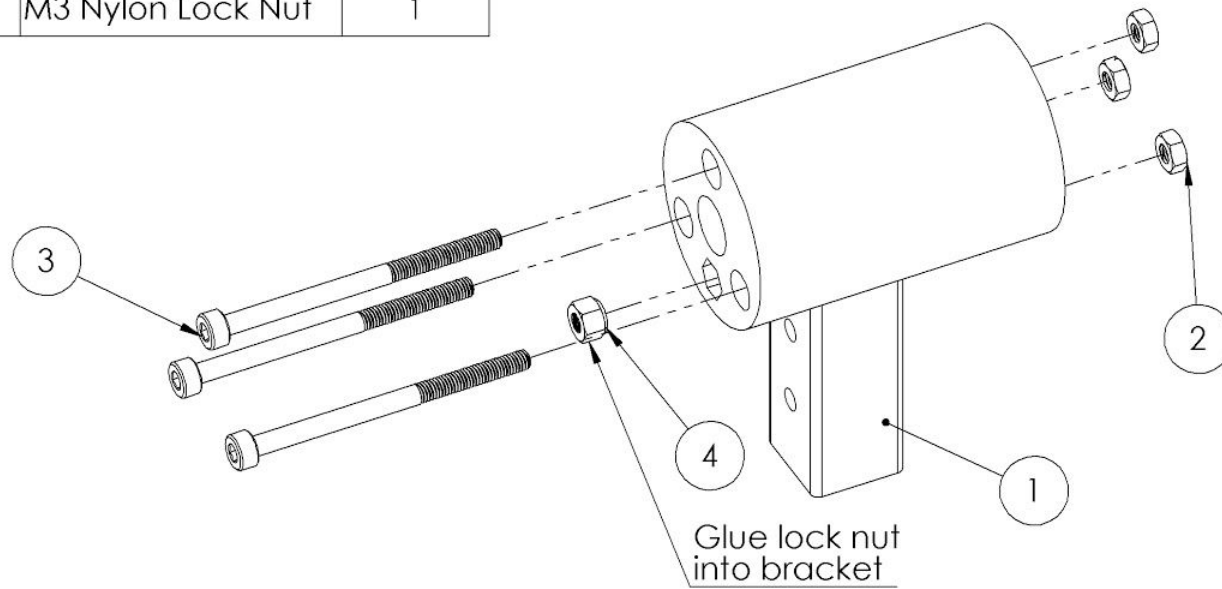

Spindle Head Installation

ITEM NO.	PART NUMBER	QTY.
1	Spindle Head Assembly	1
2	Printed bracket 7	1
3	#8 x 3/4" Hex Head Screw	2
4	#8 Flat Washer	2

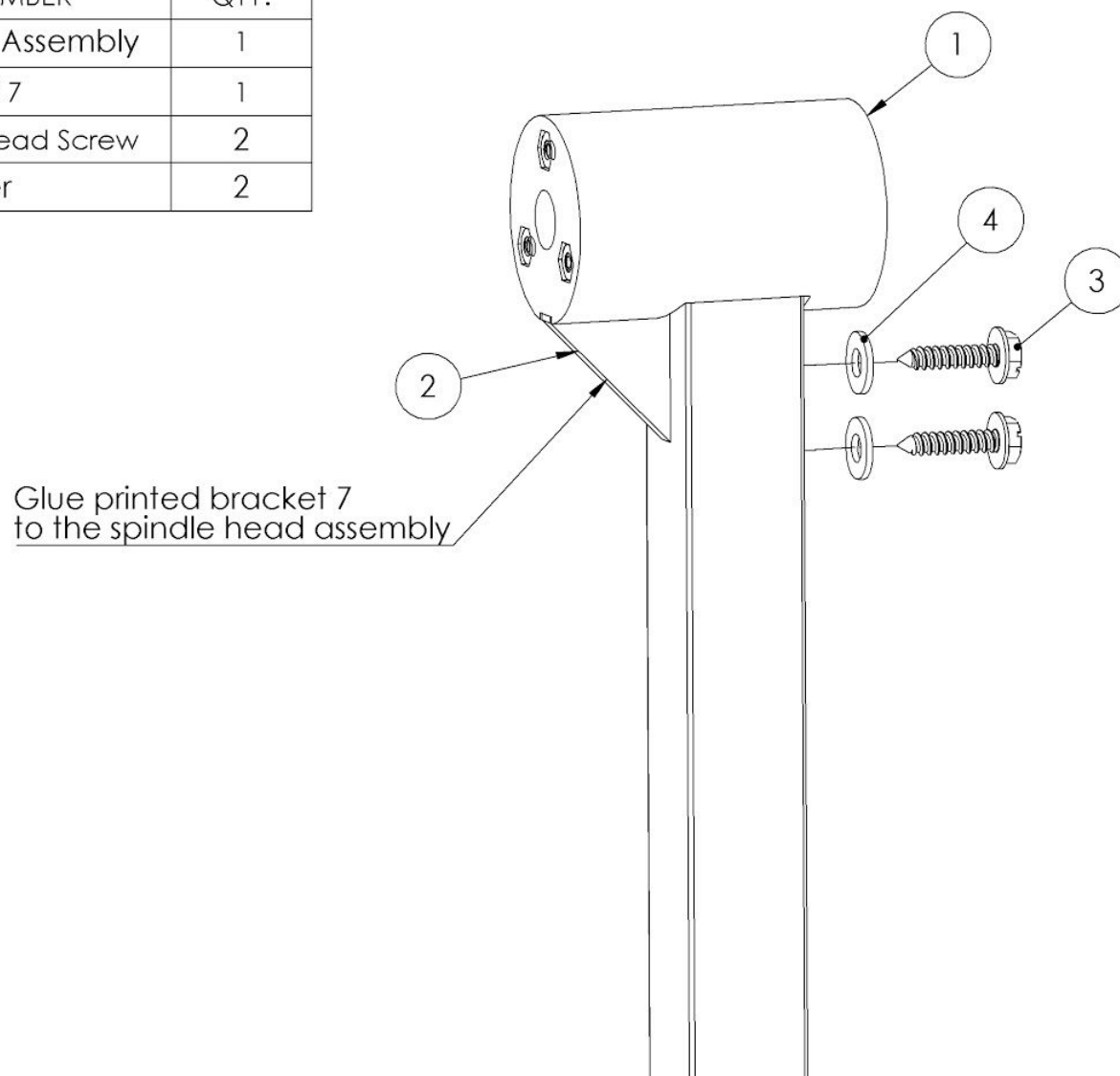

Flange Assembly

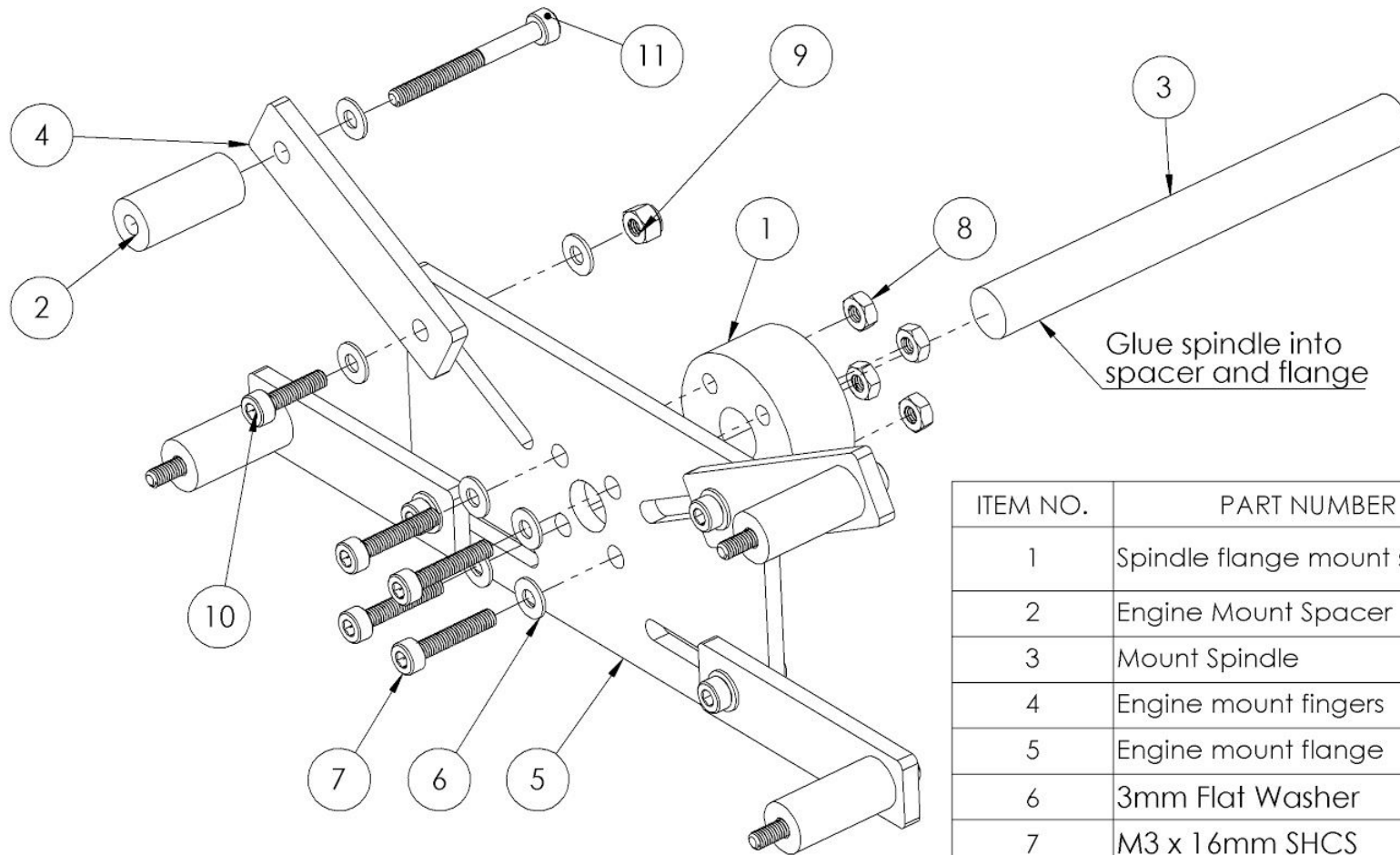

ITEM NO.	PART NUMBER	QTY.
1	Spindle flange mount spacer	1
2	Engine Mount Spacer	4
3	Mount Spindle	1
4	Engine mount fingers	4
5	Engine mount flange	1
6	3mm Flat Washer	16
7	M3 x 16mm SHCS	4
8	M3 Hex Nut	4
9	M3 Nylon Lock Nut	4
10	M3 x 12mm SHCS	4
11	M3 x 30mm SHCS	4

Spindle Assembly Installation

ITEM NO.	PART NUMBER	QTY.
1	Spindle spacer handle mount - No Glue	1
2	M3 x 8mm Set Screw	2
3	M3 Hex Nut	2
4	Handle	1
5	Handle 2	1

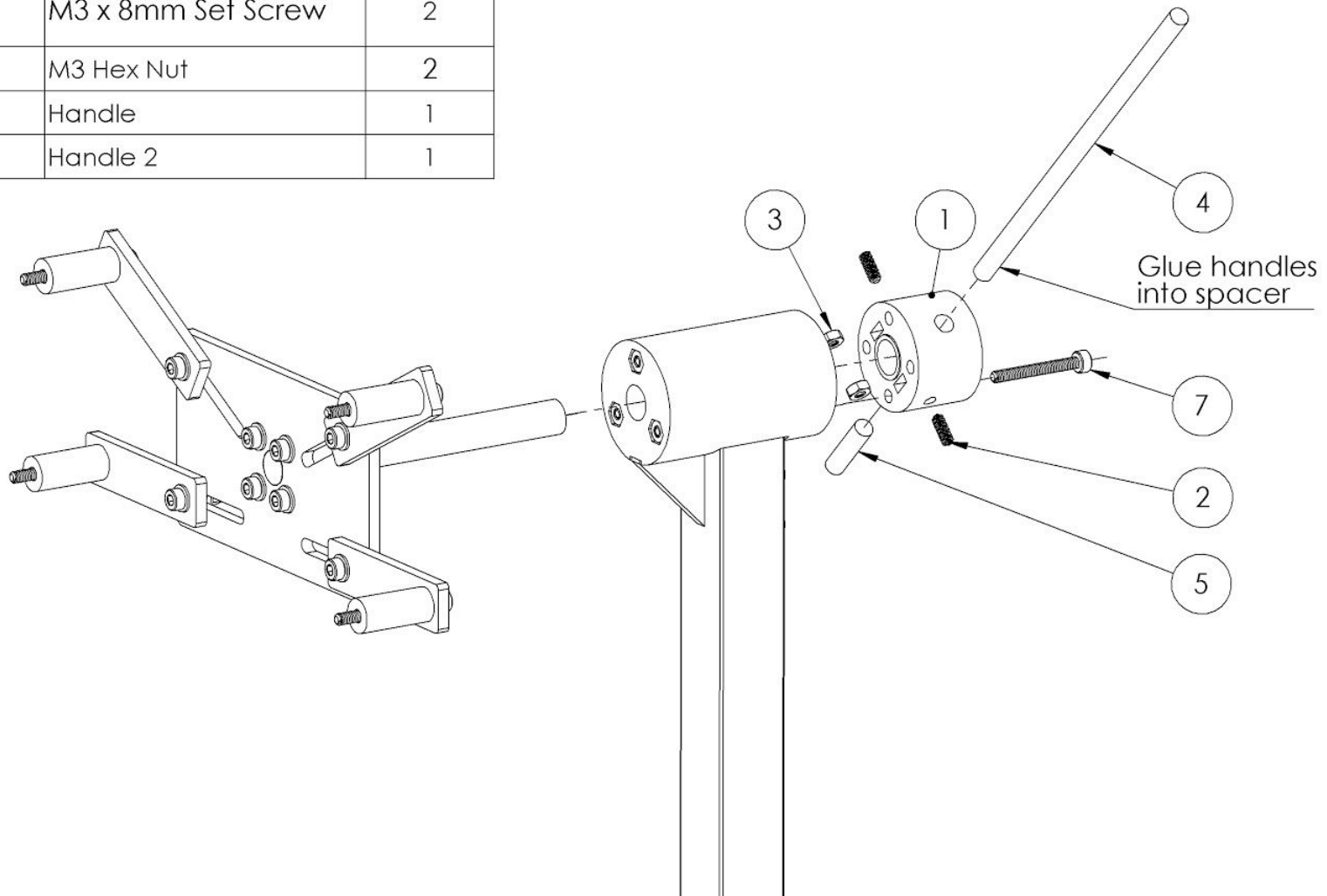



ITEM NO.	PART NUMBER	QTY.
1	Wheel Spacer 2	2
2	Wheel spacer	4
3	Caster Wheel Bracket	2
4	Caster wheel flange	2
5	Fixed Wheel	2
6	608ZZ Bearing	2
7	3mm Flat Washer	10
8	3mm Fender Washer	4
9	M3 Hex Nut	2
10	M3 Nylon Lock Nut	4
11	M3 x 35mm SHCS	2
12	M3 x 18mm SHCS	4
13	#8 Flat Washer	2
14	#8 x 3/4" Hex Screw	2

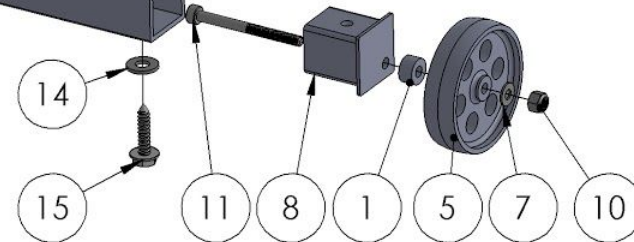

Wheel Assembly